

The Courses Down the
Greek from the Elm
to the White oak are
S. 79 W. 50
S. 58 W. 8
S. 34 W. 70

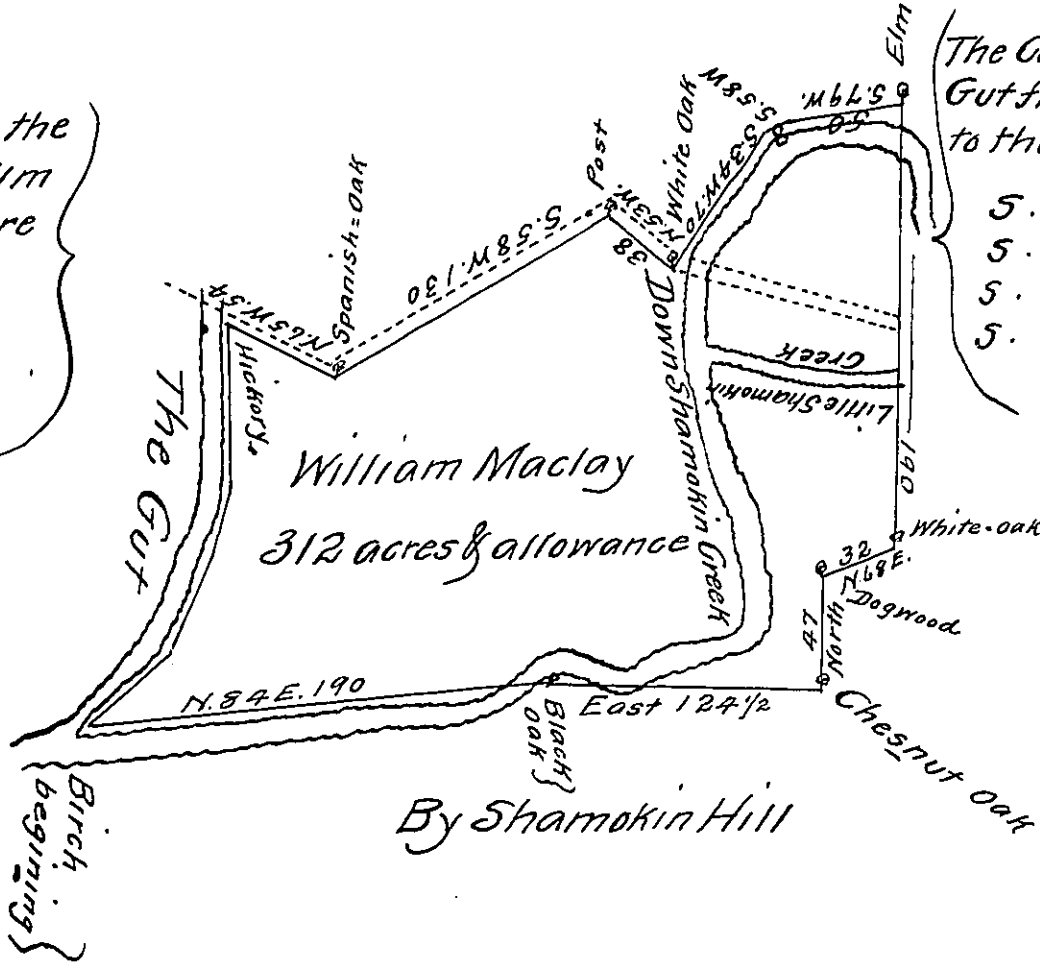

The Courses down the
Gut from the Hickory
to the Birch are

S. 3 E. 66
S. 10 W. 26 1/2
S. 23 W. 44
S. 45 W. 46

The Draught of a Tract of Land called _____ Situate on Shamokin
Greek in Augusta Township Northumberland County being Part
of the Manor of Pomfret Containing Three Hundred and Twelve
acres besides the usual allowance of Six p Cent for Roads & c^a
Surveyed the 17th day of January 1775 for William Maclay in
in Pursuance of a Warrant from the Honble Proprietaries to him
Bearing date at Philadelphia the 10th day of March Anno Dom-
-ini 1774

by Cha^s Stewart

To John Lukens Esq^r Surveyor General Deputy Survey^r

IN TESTIMONY that the above is a copy of the original remaining on file in
the Department of Internal Affairs of Pennsylvania, made
conformably to an Act of Assembly approved the 16th day of
February, 1833, I have hereunto set my Hand and caused
the Seal of said Department to be affixed at Harrisburg,
this Seventeenth day of January 1912

Henry Houch
Secretary of Internal Affairs.